

PANEL CUT-OUT

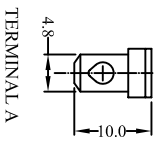
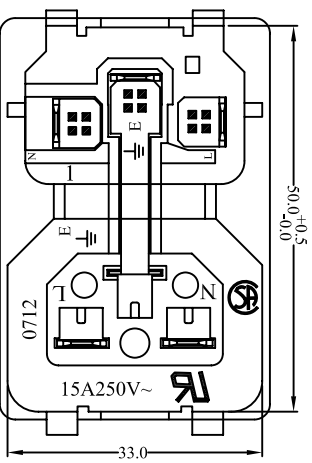

- A: MATERIAL:
 1. HOUSING: PA66 UL 94V-2 STD(94V-0 ON REQUEST)
 2. TERMINAL: COPPER ALLOY
- B: CHARACTERISTICS:
 1. RATING: 15A 250V~ NORTH AMERICA
 10A 250V~ EUROPE
 2. INSULATION RESISTANCE: OVER 100M Ω 500V DC
 3. DIELECTRIC STRENGTH: AC2000V 0.5mA ONE MINUTE
- C: APPROVALS:
 CCC, UL, CSA, VDE
- D: ORDERING OPTIONS GUIDE:

6	T-07RQ	TERMINAL	2 PCS	Ø4.8×0.8t	COPPER ALLOY	TIN-PLATED
5	T-08Q	TERMINAL	2 PCS	Ø4.8×0.8t	COPPER ALLOY	TIN-PLATED
4	T-12Q	TERMINAL	1 PCS	SNAP-IN TYPE	COPPER ALLOY	TIN-PLATED
3	T-1207PA	TERMINAL	1 PCS	SNAP-IN TYPE	COPPER ALLOY	TIN-PLATED
2	T-1207PB	TERMINAL	2 PCS	SNAP-IN TYPE	COPPER ALLOY	TIN-PLATED
1	H-12-P-G	HOUSING	19g	SNAP-IN TYPE	PA66	THERMOPLASTIC

深圳市仁达电子有限公司
 SHEN ZHEN STEADY ELECTRONICS CORPORATION

PART NO.: 0712-PQ-G
 NAME: AC INLET 3P WITH FUSE SWITCH

TOLERANCE UNLESS OTHERWISE MARKED
 DIMENSION: 0 ~ 6 : ±0.1
 6 ~ 30 : ±0.2
 30 ~ 120 : ±0.3

MATERIAL: SEE ABOVE
 SPEC.:
 APPROVED: CHECKED: DRAW BY: 谢莉萍
 JOB NO.:

REV	DATE	DESCRIPTION	WRITE	APPD.
4				

UNIT: mm	SCALE 1:1	SHEET 1 OF 1
----------	-----------	--------------