

THICKNESS:
 0.8~1.2t (X=20.3)
 1.3~2.0t (X=20.5)

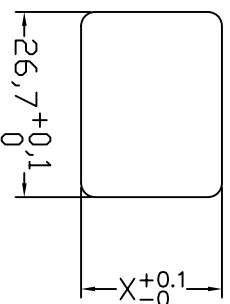

PANEL CUT

A: MATERIAL:
 1. HOUSING: NYLON 66 FLAMMABILITY UL 94V-2
 (UL 94V-0 ON REQUEST)

2. TERMINAL: COPPER ALLOY

B: CHARACTERISTICS:

1. RATING: 10A250V AC UL/EUROPE
 15A250V AC CSA

2. INSULATION RESISTANCE: OVER 100MΩ 500VAC
 DIELECTRIC STRENGTH: 2000V AC 1 MINUTE

C: APPROVALS:

UL, CSA, VDE, DEMKO, SEMKO, SEV, FINIKO& NEMKO CCC, KTL
 D: ORDERING OPTIONS:

ORDER#	ITEM REQ.	TERMINAL DIFFERENCES
2111-2-P72-G	① + ②	PCB MOUNTING FOR PITCH 7.0

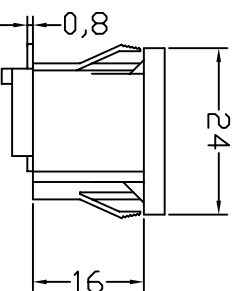
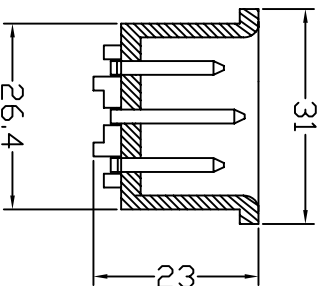

P.C.B. LAYOUT

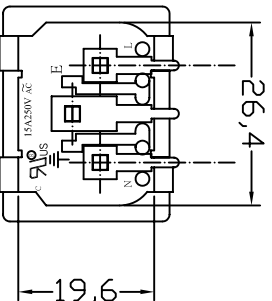

5	T-11SPB	TERMINAL	2PCS	P.C.B MOUNTING	COPPER ALLOY	TIN-PLATED
4	T-11SPA	TERMINAL	1PCS	P.C.B MOUNTING	COPPER ALLOY	TIN-PLATED
3	T-07PB	TERMINAL	2PCS		COPPER ALLOY	TIN-PLATED
2	T-07PA	TERMINAL	1PCS		COPPER ALLOY	TIN-PLATED
1	IH-11-2P-G	HOUSING	5.3g	SNAP-IN TYPE	PA66	THERMOPLASTIC
ITEM	PART NO.	PART NAME	QTY	SPECIFICATION	MATERIAL	REMARKS

SHEN ZHEN STEADY ELECTRONICS CORPORATION
深圳市仁达电子有限公司

PART NO.:
 2111-2-P72-G

NAME:
 AC INLET 3P
 WITH PCB

TOLERANCE UNLESS OTHERWISE MARKED
 DIMENSION:
 0~6 : ±0.1
 6~30 : ±0.2
 30~120: ±0.3

ANGULAR
 ±0.5

MATERIAL:
 SEE ABOVE

SPEC.:

APPROVED _____ CHECKED _____ DRAW BY 谢莉萍 JOB NO.:

REV	DATE	RE. DRAWING	DESCRIPTION	WRITE	APPL.
A.0	2008.05.15			谢莉萍	

UNIT	SCALE	SHEET
mm	1:1	1 OF 1