

THICKNESS:  
 0.8~1.2t (X=20.3)  
 1.3~2.0t (X=20.5)

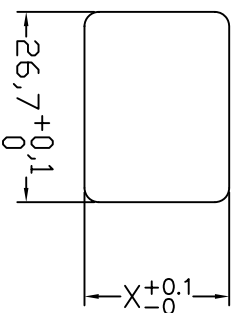

PANEL CUT

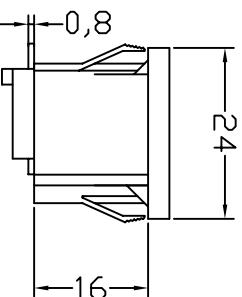
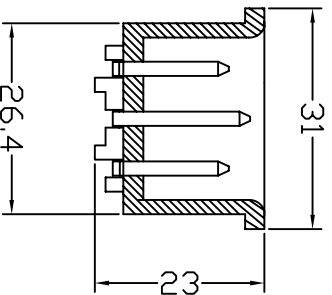

P.C.B. LAYOUT

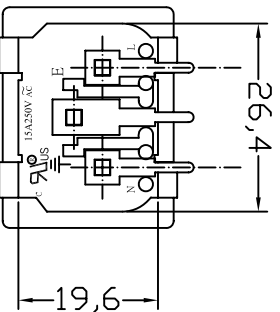

- A:MATERIAL:  
 1. HOUSING:NYLON 66 FLAMMABILITY UL 94V-2  
 (UL 94V-0 ON REQUEST)  
 2. TERMINAL:COPPER ALLOY

- B:CHARACTERISTICS:  
 1. RATING:10A250V AC UL/EUROPE  
 15A250V AC CSA  
 2. INSULATION RESISTANCE:OVER 100MΩ 500VAC  
 DIELECTRIC STRENGTH:2000V AC 1 MINUTE

- C:APPROVALS:  
 UL, CSA, VDE, DEMKO, SEMKO, SEV, FIMKO & NEMKO CCC, KTL  
 D:ORDERING OPTIONS:

ORDER#	ITEM	REQ.	TERMINAL DIFFERENCES
2111-2-P72-2-G	① + ②		PCB MOUNTING FOR PITCH 7.0

5	T-11SPB	TERMINAL	2PCS	P.C.B MOUNTING	COPPER ALLOY	TIN-PLATED
4	T-11SPA	TERMINAL	1PCS	P.C.B MOUNTING	COPPER ALLOY	TIN-PLATED
3	T-07PB	TERMINAL	2PCS		COPPER ALLOY	TIN-PLATED
2	T-07PA	TERMINAL	1PCS		COPPER ALLOY	TIN-PLATED
1	H-11-2P-2-G	HOUSING	5.3g	SNAP-IN TYPE	PA66	THERMOPLASTIC
ITEM	PART NO.	PART NAME	QTY	SPECIFICATION	MATERIAL	REMARKS

**SHENSTEADY**  
 深圳市仁达电子有限公司  
 SHEN ZHEN STEADY ELECTRONICS CORPORATION

TOLERANCE UNLESS OTHERWISE MARKED  
 DIMENSION:  
 0~6 : ±0.1  
 6~30 : ±0.2  
 30~120: ±0.3

ANGULAR  
 ±0.5

MATERIAL:  
 SEE ABOVE

NAME:  
 AC INLET 3P  
 WITH PCB

SPEC.:

REV	A.0	DATE	2008.05.15	RE. DRAWING	DESCR.PTION	WRITE	APPR.
						谢莉萍	

REV	A.0	DATE	2008.05.15	RE. DRAWING	DESCR.PTION	WRITE	APPR.
						谢莉萍	

APPROVED

CHECKED

DRAW BY 谢莉萍  
 08/05/15

JOB NO.: