

- A: MATERIAL:  
 1. HOUSING: PBT WITH +30% GLASS FIBER UL 94V-0  
 2. TERMINAL: COPPER ALLOY
- B: CHARACTERISTICS:  
 1. RATING: 12V LCD/3.5A DC  
 2. INSULATION RESISTANCE: OVER 5M $\Omega$  500V DC  
 3. DIELECTRIC STRENGTH: 1000V AC ONE MINUTE

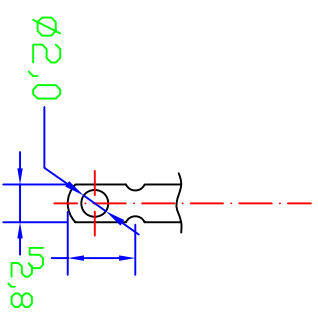
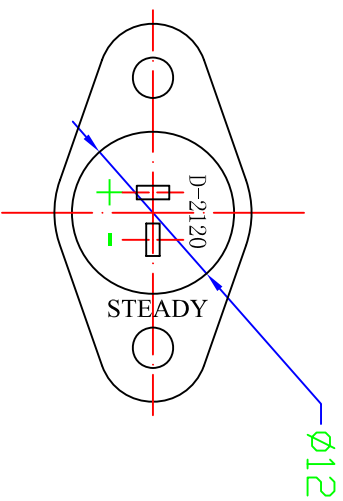

深圳市仁达电子有限公司  
 SHEN ZHEN STEADY ELECTRONICS CORPORATION

TOLERANCE UNLESS OTHERWISE MARKED

DIMENSION: ANGULAR  $\pm 0.5$

0-6:  $\pm 0.1$

6-18:  $\pm 0.3$

18-50:  $\pm 0.5$

A		UNIT: mm	SCALE: 2:1	SHEET: 1 OF 1
3				

PART NO.: D-2120-CS1-G  
 NAME: DC JACK

MATERIAL: Housing: PBT+30%GF  
 Terminal: BRASS

SPEC.: 12V DC 2-4A  
 36V DC 1-2A

APPROVED: CHECKED: DRAWN:

侯物强

07.11.28

NOTE: REV.: B  
 JOB NO.: