

THICKNESS:  
0.8t, 1.0t, 1.2t

A: MATERIAL:  
1. HOUSING: PA66 UL 94V-2 STD(94V-0 REQUEST)  
2. TERMINAL: COPPER ALLOY

B: CHARACTERISTICS:  
1. RATING: 10A250V AC  
2. INSULATION RESISTANCE, DIELECTRIC STRENGTH PER APPROVAL SHEET  
3. FUSE:  $\phi 5 \times 20$ mm

C: APPROVALS:  
UL, CSA, VDE, DEMKO, SEMKO, SEV, FIMKO & NEMKO, CCC

D: ORDERING OPTIONS:

ORDER#	TERMINAL
2117-IS-PQ10-G	4.8 SOLDER Q.D. TABS

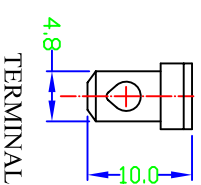
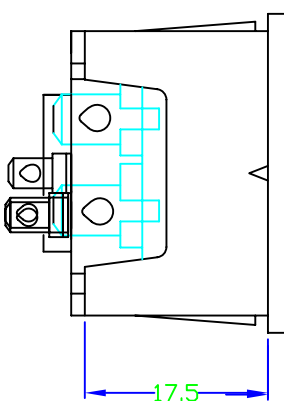
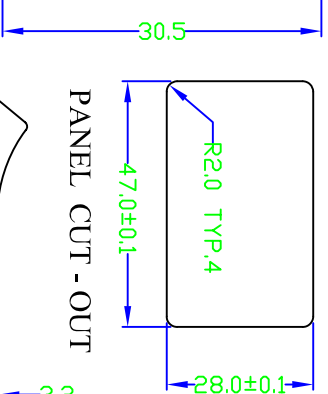
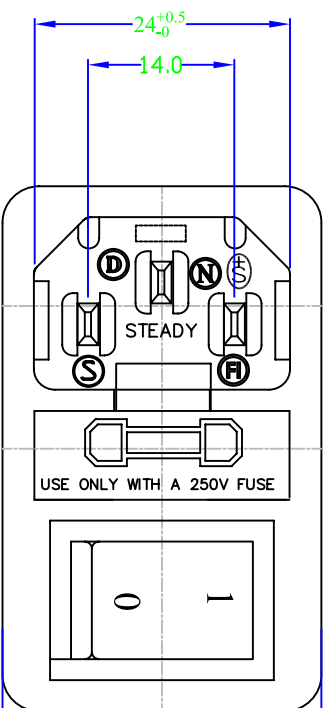

TERMINAL ROCKER SWITCH TERMINAL

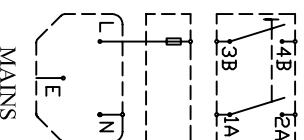
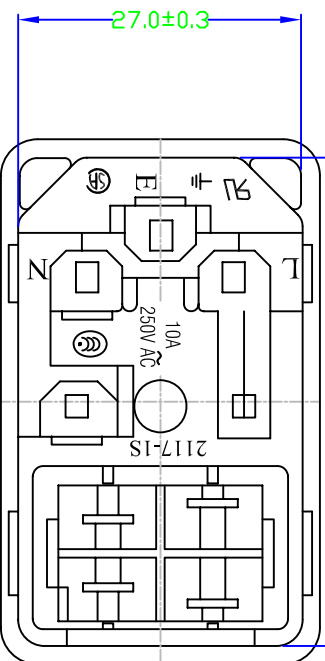
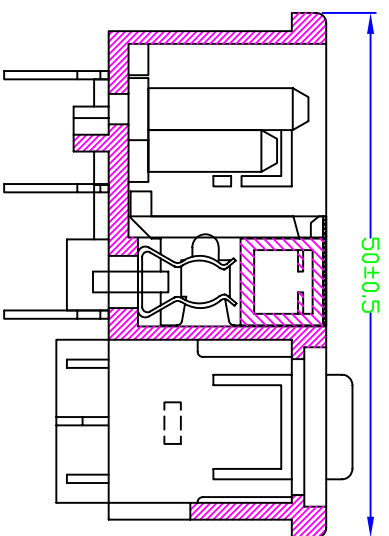

ITEM	PART NO.	PART NAME	QTY	SPECIFICATION	MATERIAL	REMARKS
5		ROCKER SWITCH	1			
4	T-17-1Q	TERMINAL	1 SET	4.8x0.8t	COPPER ALLOY	TIN-PLATED
3	T-17-1LS	TERMINAL	1 SET	2.8x0.8t	COPPER ALLOY	TIN-PLATED
2	H-13FH	FUSE HOLDER	1	$\phi 5 \times 20$ mm	PA 66	
1	H-17-1PS	HOUSING	1	SNAP-IN TYPE	PA 66	

**深圳市仁达电子有限公司**  
SHEN ZHEN STEADY ELECTRONICS CORPORATION

TOLERANCE UNLESS OTHERWISE MARKED  
DIMENSION: ANGULAR  
.000 : ±0.05  
.00 : ±0.1  
.0 : ±0.2

PART NO.: 2117-IS-PQ10-G  
NAME: AC INLET 3P WITH FUSE/SWITCH

MATERIAL: SEE ABOVE  
SPEC: —

APPROVED: \_\_\_\_\_  
CHECKED: \_\_\_\_\_  
DRAWN: 侯锡强

NOTE

UNIT:	SCALE	SHEET	JOB NO.:
mm	2:1	1 OF 1	07.11.28