

THICKNESS: 1.65t

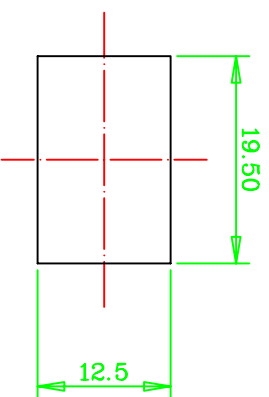

PANEL CUT-OUT

- A: MATERIAL:
1. HOUSING: PBT WITH +30% GLASS FIBER UL 94V-0
  2. TERMINAL: COPPER ALLOY

B: CHARACTERISTICS:

1. RATING: 2.5A/250V AC
2. INSULATION RESISTANCE: OVER 100MΩ AT 500V DC
3. DIELECTRIC STRENGTH :2000V AC ONE MINUTE

C: APPROVALS:

UL, CSA, VDE, SEMKO, SEV &, NEMKO, CCC

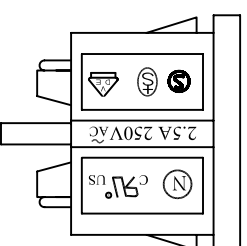
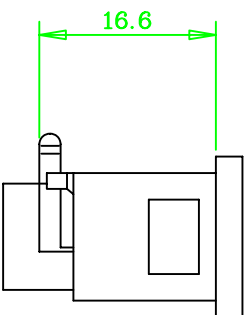

ITEM	PART NO.	PART NAME	QTY	SPECIFICATION	MATERIAL	REMARKS
2	T-21P	TERMINAL	1 set	PCB MOUNTING TYPE	COPPER ALLOY	TIN-PLATED
1	H-21-3-P	HOUSING	1	SNAP-IN TYPE	PBT+30 %GF	UL 94V-0

PCB LAYOUT

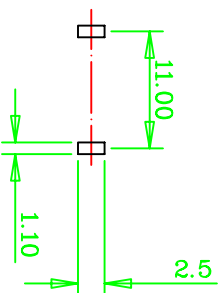

<b>深圳市仁达电子有限公司</b> SHEN ZHEN STEADY ELECTRONICS CORPORATION		<b>PART NO.:</b> 2121-3-PP-G		<b>NAME:</b> SNAP-IN TYPE AC INLET 2P	
<b>TOLERANCE UNLESS OTHERWISE MARKED</b> DIMENSION: 0~6 : ±0.1 6~30 : ±0.3 30~120: ±0.5		<b>MATERIAL:</b> SEE ABOVE		<b>SPEC.:</b> —	
<b>ANGULAR</b> ±0.5		<b>APPROVED</b>	<b>CHECKED</b>	<b>DRAW BY</b> 侯锡强 07.11.28	<b>REV:</b> A
<b>UNITS:</b> mm	<b>SCALE</b> 1:1	<b>SHEET</b> 1 OF 1		<b>JOB NO.:</b>	